

CIVIL IMPROVEMENT PLANS FOR CARSON HIGH SCHOOL PARKING LOT

APN:010-041-64
CARSON CITY, NEVADA

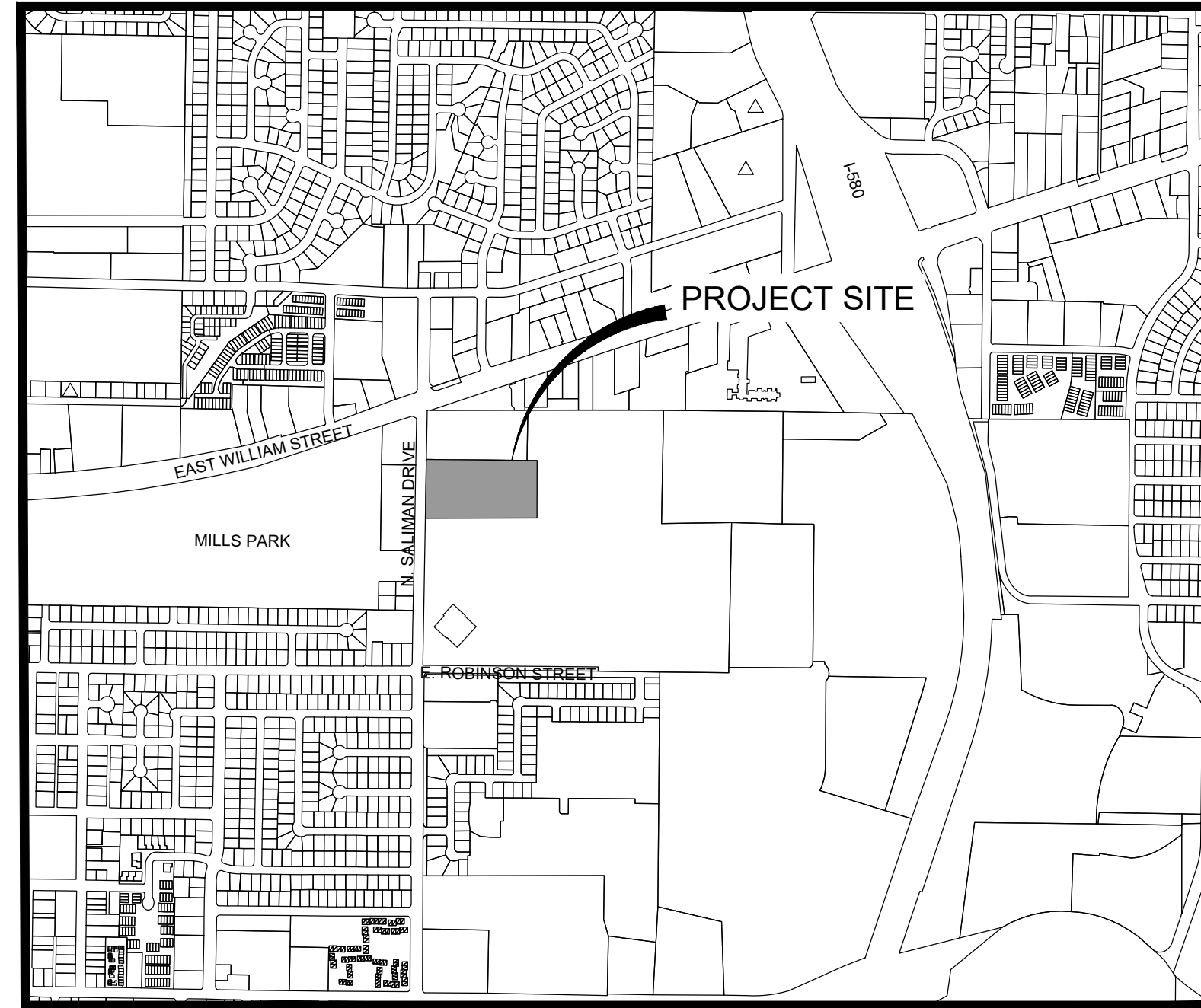

VICINITY MAP
NTS

Manhard
CONSULTING LTD

241 Ridge Street, Suite 400, Reno, NV 89501 ph:775-748-3500 fx:775-748-3500 manhard.com
Civil Engineers • Surveyors • Water Resources Engineers • Water & Wastewater Engineers
Construction Managers • Environmental Scientists • Landscape Architects • Planners

OWNER
CARSON CITY SCHOOL DISTRICT.
1402 W. KING STREET
CARSON CITY, NV 89703
(775) 283-2100

CIVIL
MANHARD CONSULTING, LTD
241 RIDGE STREET, SUITE 400
RENO, NEVADA 89501
(775) 746-3500

GEOTECH ENGINEER
WOOD RODGERS
1361 CORPORATE BOULEVARD
RENO, NV 89502
(775) 823-4068

SURVEYOR
MANHARD CONSULTING, LTD
241 RIDGE STREET, SUITE 400
RENO, NEVADA 89501
(775) 746-3500

STANDARD SYMBOLS

EXISTING		PROPOSED
	STORM SEWER	
	SANITARY SEWER	
	WATER MAIN	
	GAS	
	ELECTRIC	
	TELEPHONE	
	SANITARY MANHOLE	
	SANITARY CLEANOUT	
	STORM MANHOLE	
	CATCH BASIN	
	SWPPP FEATURES	
	RIP RAP	
	FLARED END SECTION HEADWALL	
	STREET LIGHT	
	DITCH OR SWALE	
	DIRECTION OF FLOW	
	2 FOOT CONTOURS	
	ROADWAY GRADE BREAK	
	CURB AND GUTTER	
	CONCRETE WALK	
	ACCESSIBLE CURB RAMP	
	PROPERTY LINE	
	SIGN	
	POWER POLE	
	GUY WIRE	
	GAS VALVE	
	ELECTRICAL BOX	
	TELEPHONE PEDISTAL	
	CHAIN-LINK FENCE	
	TOP OF CURB ELEVATION	
	EDGE OF PAVEMENT ELEVATION	
	TOP OF WALL ELEVATION	
	FINISH GRADE ELEVATION	
	GRADE BREAK ELEVATION	
	FLOWLINE ELEVATION	
	ROCKERY WALL	
	RETAINING WALL	
	LANDSCAPE WALL	
	CLASS "A" MONUMENT	

UTILITIES

CABLE	-	CHARTER COMMUNICATIONS
PHONE	-	AT&T
ELECTRICAL	-	NV ENERGY
GAS	-	NV ENERGY
SEWER	-	CITY OF RENO
STORM DRAIN	-	CITY OF RENO
SOLID WASTE	-	WASTE MANAGEMENT
WATER	-	TRUCKEE MEADOWS WATER AUTHORITY

ABBREVIATIONS

AGG.	AGGREGATE GRAVEL	FL	FLOW LINE	PVT	POINT OF VERTICAL TANGENCY
B.A.M.A.	BIT. AGG. MIXTURE	FM	FORCE MAIN	R	RADIUS
B-B	BACK TO BACK	FG	FINISH GRADE	RCP	REINFORCED CONCRETE PIPE
BC	BEGINNING OF CURVE	GAS	GAS	ROW	RIGHT-OF-WAY
BFC	BACK FACE OF CURB	GW	GUY WIRE	RR	RAILROAD
BIT.	BITUMINOUS CONCRETE	HDWL	HEADWALL	SD	STORM DRAIN
BM	BENCHMARK	HH	HANDHOLE	SDMH	STORM DRAIN MANHOLE
B.O.	BY OTHERS	HP	HIGH POINT	SF	SQUARE FOOT
B/P	BOTTOM OF PIPE	HWL	HIGH WATER LEVEL	SHLD.	SHOULDER
BVC	BEGINNING OF VERTICAL CURVE	HYD.	HYDRANT	SL	STREET LIGHT
BW	BOTTOM OF WALL	I.E.	INVERT ELEVATION	SS	SANITARY SEWER
CB	CATCH BASIN	INL	INLET	SSMH	SANITARY SEWER MANHOLE
CL	CENTERLINE	INV.	INVERT	STA.	STATION
CMP	CORRUGATED METAL PIPE	IP	IRON PIPE	SY	SQUARE YARDS
CNTRL	CONTROL	LFF	LOWER FINISHED FLOOR	T	TELEPHONE
CONC.	CONCRETE	LGAR	LIP OF GARAGE	TBR	TO BE REMOVED
CY	CUBIC YARD	LXFG	LOWER EXTERIOR FINISHED GRADE	TC	TOP OF CURB
D	DITCH	LP	LOW POINT	TOS	TOP OF SLAB
DIA.	DIAMETER	MAX.	MAXIMUM	T/P	TOP OF PIPE
DIP	DUCTILE IRON PIPE	MB	MAILBOX	TRANS	TRANSFORMER
DI	DUCTILE IRON	MIN.	MINIMUM	TW	TOP OF WALL
DT	DRAIN TILE	NWL	NORMAL WATER LEVEL	UFF	UPPER FINISHED FLOOR
(e)	EXISTING	P	PAVEMENT	UXFG	UPPER EXTERIOR FINISHED GRADE
E	ELECTRIC	PC	POINT OF CURVE	VB	VALVE BOX
EC	END OF CURVE	PCC	POINT OF COMPOUND CURVE	VV	VALVE VAULT
E-E	EDGE TO EDGE	PI	POINT OF INTERSECTION	WL	WATER LEVEL
ELEV.	ELEVATION	PL	PROPERTY LINE	WM	WATER MAIN
EP	EDGE OF PAVEMENT	PP	POWER POLE		
EVC	END OF VERTICAL CURVE	PROP.	PROPOSED		
EX.	EXISTING	PT	POINT OF TANGENCY		
FES	FLARED END SECTION	PVC	POLYVINYL CHLORIDE PIPE		
F-F	FACE TO FACE	PVC	POINT OF VERTICAL CURVE		
FF	FINISHED FLOOR	PVI	POINT OF VERTICAL INTERSECTION		

SHEET LIST TABLE

SHEET NUMBER	SHEET TITLE
01	TITLE SHEET
02	PARKING LOT REHABILITATION PLAN - EAST LOT
03	PARKING LOT REHABILITATION PLAN - WEST LOT
04	SIGNAGE AND STRIPING-EAST LOT
05	SIGNAGE AND STRIPING-WEST LOT
06	DETAIL SHEET

UTILITIES

CABLE	-	CHARTER COMMUNICATIONS
PHONE	-	AT&T
ELECTRICAL	-	NV ENERGY
GAS	-	SOUTHWEST GAS
SEWER	-	CARSON CITY PUBLIC WORKS
SOLID WASTE	-	CAPITOL SANITATION
WATER	-	CARSON CITY PUBLIC WORKS

BASIS OF BEARINGS

MODIFIED NEVADA STATE PLANE COORDINATE SYSTEM, WEST ZONE, NORTH AMERICAN DATUM OF 1983 (NAD 83/94) DETERMINED USING REAL TIME KINEMATIC GPS (RTK GPS) OBSERVATIONS OF CARSON CITY CONTROL MONUMENTS CC019 AND CC020 AS SHOWN ON RECORD OF SURVEY MAP NO. 2749 RECORDED AUGUST 11, 2010 IN THE OFFICIAL RECORDS OF CARSON CITY NEVADA, AS FILE NO. 403425. COMBINED GRID TO GROUND FACTOR = 1.0002. ALL DISTANCES SHOWN HEREIN ARE GROUND VALUES.

BASIS OF ELEVATION

NORTH AMERICAN VERTICAL DATUM OF 1988 (NVAD88), AS TAKEN FROM CARSON CITY CONTROL MONUMENT CC019, HAVING A PUBLISHED ELEVATION OF 4643.03 U.S. FEET. CC09 IS DESCRIBED AS A 2 INCH BRASS DISK STAMPED "CC019 2010" LOCATED AT THE SOUTH RETURN OF THE NORTHWEST CORNER OF GOLDFIELD AVENUE AND SOUTH SALIMAN ROAD.

ENGINEER'S STATEMENT

TO THE BEST OF OUR KNOWLEDGE AND BELIEF, THESE PLANS HAVE BEEN PREPARED IN ACCORDANCE WITH ACCEPTED ENGINEERING PROCEDURES AND GUIDELINES, AND ARE IN SUBSTANTIAL COMPLIANCE WITH APPLICABLE STATUTES, CITY ORDINANCES, AND CODES. IN THE EVENT OF A CONFLICT BETWEEN ANY PORTION OF THESE PLANS AND THE CITY CODES, THE CITY CODES SHALL PREVAIL.

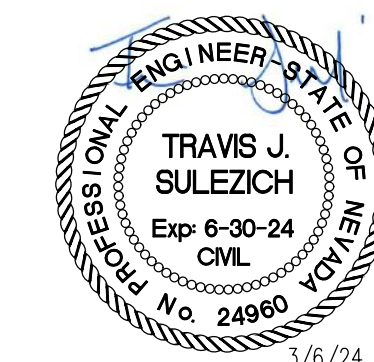

TRAVIS J. SULEZICH

P.E. #24960

DATE	REVISIONS	CHECK BY

Manhard
CONSULTING LTD
241 Ridge Street, Suite 400, Reno, NV 89501 ph:775-748-3500 fx:775-748-3500 manhard.com
Civil Engineers • Surveyors • Water Resources Engineers • Water & Wastewater Engineers
Construction Managers • Environmental Scientists • Landscape Architects • Planners

CARSON HIGH SCHOOL PARKING LOT
CARSON CITY, NEVADA
TITLE SHEET

PROJ MGR: TJS
PROJ ASSOC: AR
DRAWN BY: AR
DATE: 3/06/24
SCALE: AS SHOWN
SHEET
01 OF **06**
CCSDCCCN7

March 4, 2024 - 10:31 Date Name: P:\cadd\c07\carh\plan\final\Drawings\Plan_S&T\Title_Sheet.dwg User: jldwgs



CONSTRUCTION DRAWINGS

EX. CHANNEL

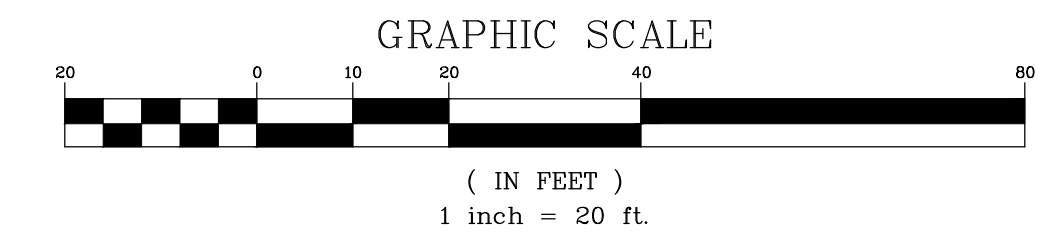

NOTES

1. ADD 4600 FEET TO ALL SPOT ELEVATIONS.
2. CONTRACTOR TO COORDINATE PHASING OF PARKING LOT CONSTRUCTION WITH CARSON CITY SCHOOL DISTRICT PRIOR TO THE COMMENCEMENT OF CONSTRUCTION.
3. CONTRACTOR TO REFERENCE GEOTECHNICAL REPORT PREPARED BY WOOD ROGERS DATED NOVEMBER 3, 2023 FOR ALL RECOMMENDATIONS.
4. DUST SHALL BE CONTROLLED BY THE CONTRACTOR TO THE SATISFACTION OF THE CITY AND IN ACCORDANCE WITH THE NEVADA DIVISION OF ENVIRONMENTAL PROTECTION STANDARDS.
5. CONTRACTOR SHALL BE RESPONSIBLE FOR REMOVAL OF ALL DEBRIS AS ACCEPTABLE TO THE OWNER AND ENGINEER.
6. CONTRACTOR TO CONSTRUCT FINISH GRADE OF PAVEMENT TO GRADES SHOWN ON THE PLANS. IN ALL OTHER AREAS WHERE NO GRADING IS SHOWN, CONTRACTOR TO REPLACE PAVEMENT TO ORIGINAL FINISHED GRADE ELEVATION.
7. CONTRACTOR TO ENSURE POSITIVE DRAINAGE OF PAVEMENT WITHIN THE SITE DURING REMOVAL AND REPLACE.
8. THE CONTRACTOR SHALL VERIFY IN FIELD ALL ELEVATIONS, DIMENSIONS, FLOW LINES, AND EXISTING CONDITIONS WITH ADJOINING PROPERTIES (PUBLIC OR PRIVATE). ANY DISCREPANCIES SHALL BE CALLED TO THE ATTENTION OF THE ENGINEER BEFORE PROCEEDING WITH THE WORK.
9. THE CONTRACTOR SHALL BE RESPONSIBLE FOR ANY AND ALL DAMAGE TO EXISTING UTILITIES ENCOUNTERED DURING CONSTRUCTION. IT SHALL BE THE CONTRACTOR'S RESPONSIBILITY TO CONTACT THE UTILITY COMPANIES FOR LOCATIONS OR POT HOLLING PRIOR TO CONSTRUCTIONS.
10. CONTRACTOR TO SLURRY SEAL THE ENTIRETY OF BOTH PARKING LOTS.
11. PROTECT EXISTING CHANNEL AND ALL EXISTING STORM DRAIN FACILITIES. CONTRACTOR TO NOTIFY ENGINEER OF ANY DISCREPANCIES.

LEGEND

- PARKING LOT REMOVAL AND REPLACEMENT SECTION. SEE SECTION THIS SHEET.
- BUS ROUTE REMOVAL AND REPLACEMENT SECTION. SEE SECTION THIS SHEET.
- RECENTLY RECONSTRUCTED BUS ROUTE. AREA TO REMAIN.

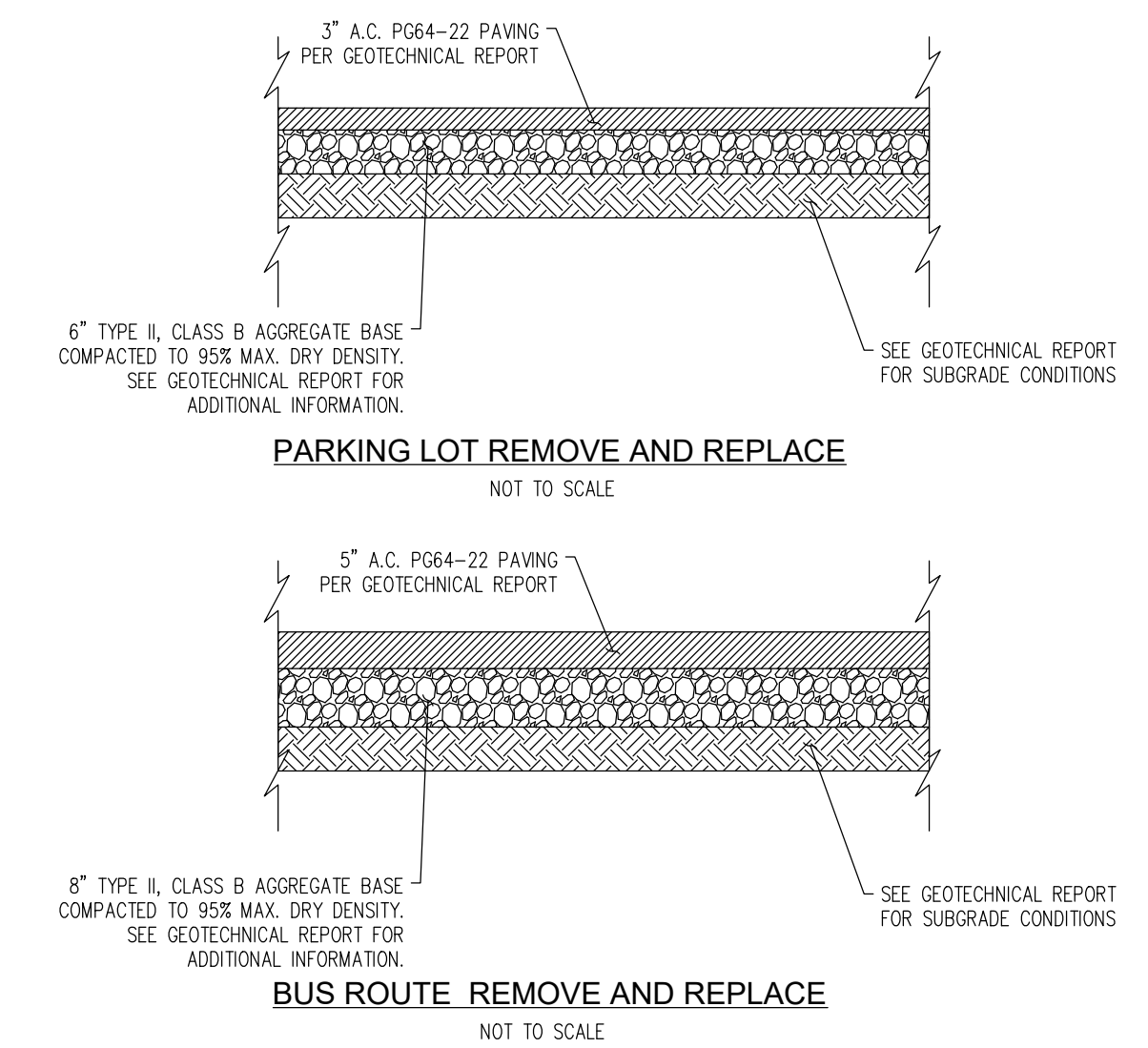

EX. ENTRANCE DRIVE AISLE

WEST LOT

EAST LOT
104,000 S.F.

CARSON HIGH SCHOOL

March 6, 2024 - 14:24 - File Name: P:\Construction\24\2405\Drawings\Plan_Site\CARSON_HHS_PARKING_PLAN\REVISED_AMAN\SSD.dwg - Plotted by: jhess

DATE	REVISIONS	CHECKED BY

Manhard CONSULTING LTD.
 841 Ridge Street, Suite 400, Reno, NV 89501 ph: 775-748-2900 fc: 775-748-2950 manhard.com
 Civil Engineers • Surveyors • Water Resource Engineers • Water & Wastewater Engineers
 Construction Management • Environmental Scientists • Landscape Architects • Planners

CARSON HIGH SCHOOL PARKING LOT
 CARSON CITY, NEVADA
 PARKING LOT REHABILITATION PLAN - EAST LOT



PROJ. MGR:	TJS
PROJ. ASSOC:	AR
DRAWN BY:	AR
DATE:	3/06/24
SCALE:	AS SHOWN
SHEET	02 OF 06
CCSDCCCN7	©2024 - ALL RIGHTS RESERVED

CONSTRUCTION DRAWINGS

March 6, 2024 - 14:24 - Plot Name: P:\Cadd\2024\Carson High School\Drawings\Plan - Saw\CARSON_High_School_Parking_Lot_Rehabilitation.dwg - Plotted by: jhs

EX. NORTH SALIMAN ROAD

EX. CHANNEL

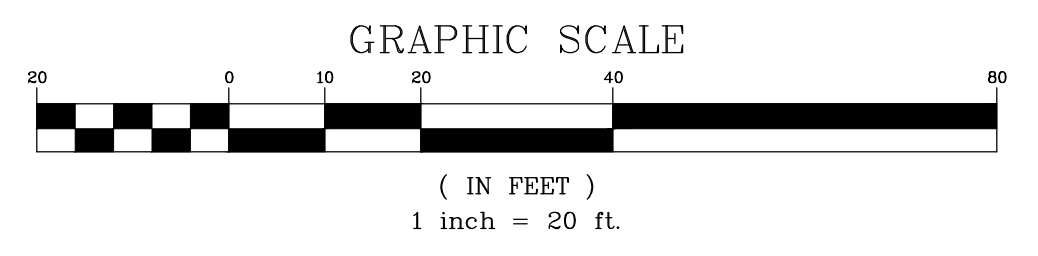
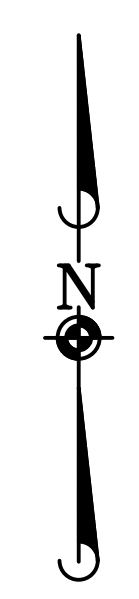
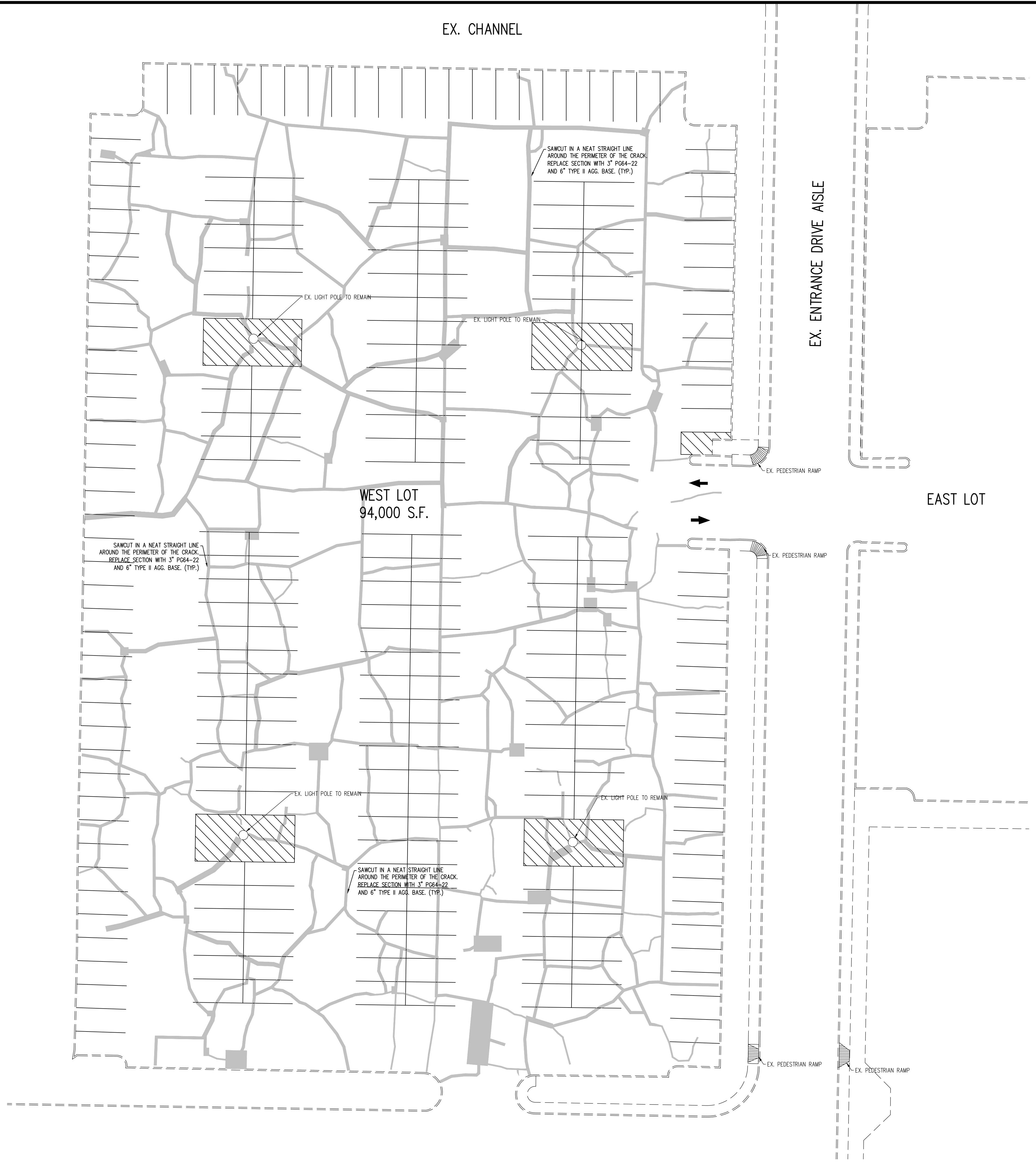

NOTES

1. ADD 4600 FEET TO ALL SPOT ELEVATIONS.
2. CONTRACTOR TO COORDINATE PHASING OF PARKING LOT CONSTRUCTION WITH CARSON CITY SCHOOL DISTRICT PRIOR TO THE COMMENCEMENT OF CONSTRUCTION.
3. CONTRACTOR TO REFERENCE GEOTECHNICAL REPORT PREPARED BY WOOD ROGERS DATED NOVEMBER 3, 2023 FOR ALL RECOMMENDATIONS.
4. DUST SHALL BE CONTROLLED BY THE CONTRACTOR TO THE SATISFACTION OF THE CITY AND IN ACCORDANCE WITH THE NEVADA DIVISION OF ENVIRONMENTAL PROTECTION STANDARDS.
5. CONTRACTOR SHALL BE RESPONSIBLE FOR REMOVAL OF ALL DEBRIS AS ACCEPTABLE TO THE OWNER AND ENGINEER.
6. CONTRACTOR TO CONSTRUCT FINISH GRADE OF PAVEMENT TO GRADES SHOWN ON THE PLANS. IN ALL OTHER AREAS WHERE NO GRADING IS SHOWN, CONTRACTOR TO REPLACE PAVEMENT TO ORIGINAL FINISHED GRADE ELEVATION.
7. CONTRACTOR TO ENSURE POSITIVE DRAINAGE OF PAVEMENT WITHIN THE SITE DURING REMOVAL AND REPLACE.
8. THE CONTRACTOR SHALL VERIFY IN FIELD ALL ELEVATIONS, DIMENSIONS, FLOW LINES, AND EXISTING CONDITIONS WITH ADJACING PROPERTIES (PUBLIC OR PRIVATE). ANY DISCREPANCIES SHALL BE CALLED TO THE ATTENTION OF THE ENGINEER BEFORE PROCEEDING WITH THE WORK.
9. THE CONTRACTOR SHALL BE RESPONSIBLE FOR ANY AND ALL DAMAGE TO EXISTING UTILITIES ENCOUNTERED DURING CONSTRUCTION. IT SHALL BE THE CONTRACTOR'S RESPONSIBILITY TO CONTACT THE UTILITY COMPANIES FOR LOCATIONS OR POT HOLE PRIOR TO CONSTRUCTIONS.
10. CONTRACTOR TO SLURRY SEAL THE ENTIRETY OF BOTH PARKING LOTS.
11. PROTECT EXISTING CHANNEL AND ALL EXISTING STORM DRAIN FACILITIES. CONTRACTOR TO NOTIFY ENGINEER OF ANY DISCREPANCIES.

LEGEND

- PARKING LOT REMOVAL AND REPLACEMENT SECTION. SEE SECTION THIS SHEET.
- BUS ROUTE REMOVAL AND REPLACEMENT SECTION. SEE SECTION THIS SHEET.
- RECENTLY RECONSTRUCTED BUS ROUTE. AREA TO REMAIN.

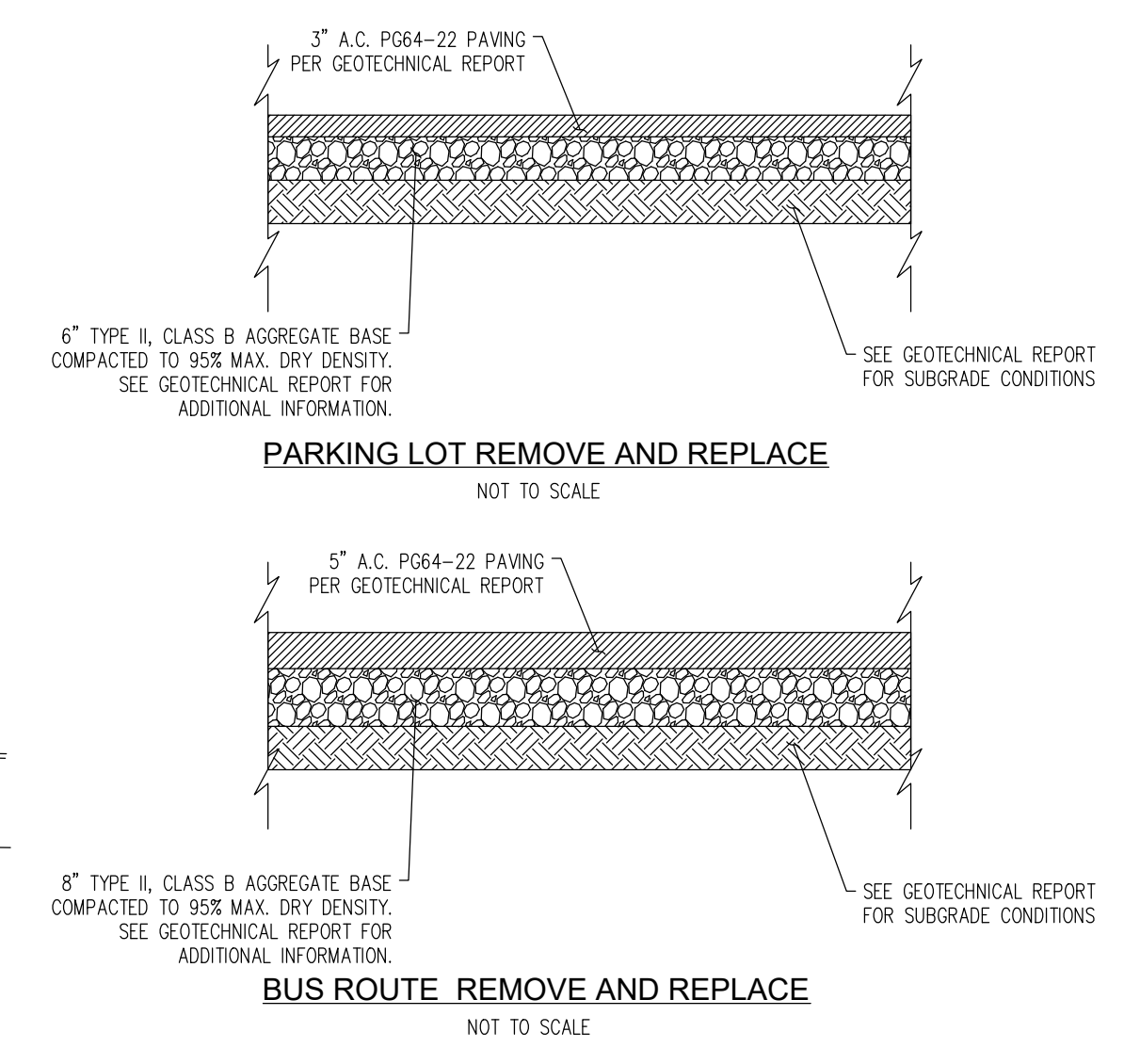

Call **811** before you Dig
Avoid cutting underground utility lines. It's costly.

DATE	REVISIONS	DRAWN BY / CHECKED BY

Manhard CONSULTING LTD.
841 Ridge Street, Suite 400, Reno, NV 89501 | ph:775.748.9901 | fx:775.748.2950
Civil Engineers • Surveyors • Water Resource Engineers • Water & Wastewater Engineers
Construction Managers • Environmental Scientists • Landscape Architects • Planners

CARSON HIGH SCHOOL PARKING LOT
CARSON CITY, NEVADA
PARKING LOT REHABILITATION PLAN - WEST LOT

PROFESSIONAL ENGINEER STATE OF NEVADA
TRAVIS J. SULEZICH
Exp 6-30-24
CIVIL
No. 24960

PROJ. MGR.: TJS
PROJ. ASSOC.: AR
DRAWN BY: AR
DATE: 3/06/24
SCALE: AS SHOWN

SHEET
03 OF **06**
CCSDCCN7

CONSTRUCTION DRAWINGS

March 6, 2024 14:24 File Name: P:\Construction\2024\Carson_High_School\Drawings\Site Plans\CARSON_High_School_PARKING_Lot_SIGNAGE AND STRIPING.dwg Plot Date: 3/6/24 By: adss

EX. NORTH SALIMAN ROAD

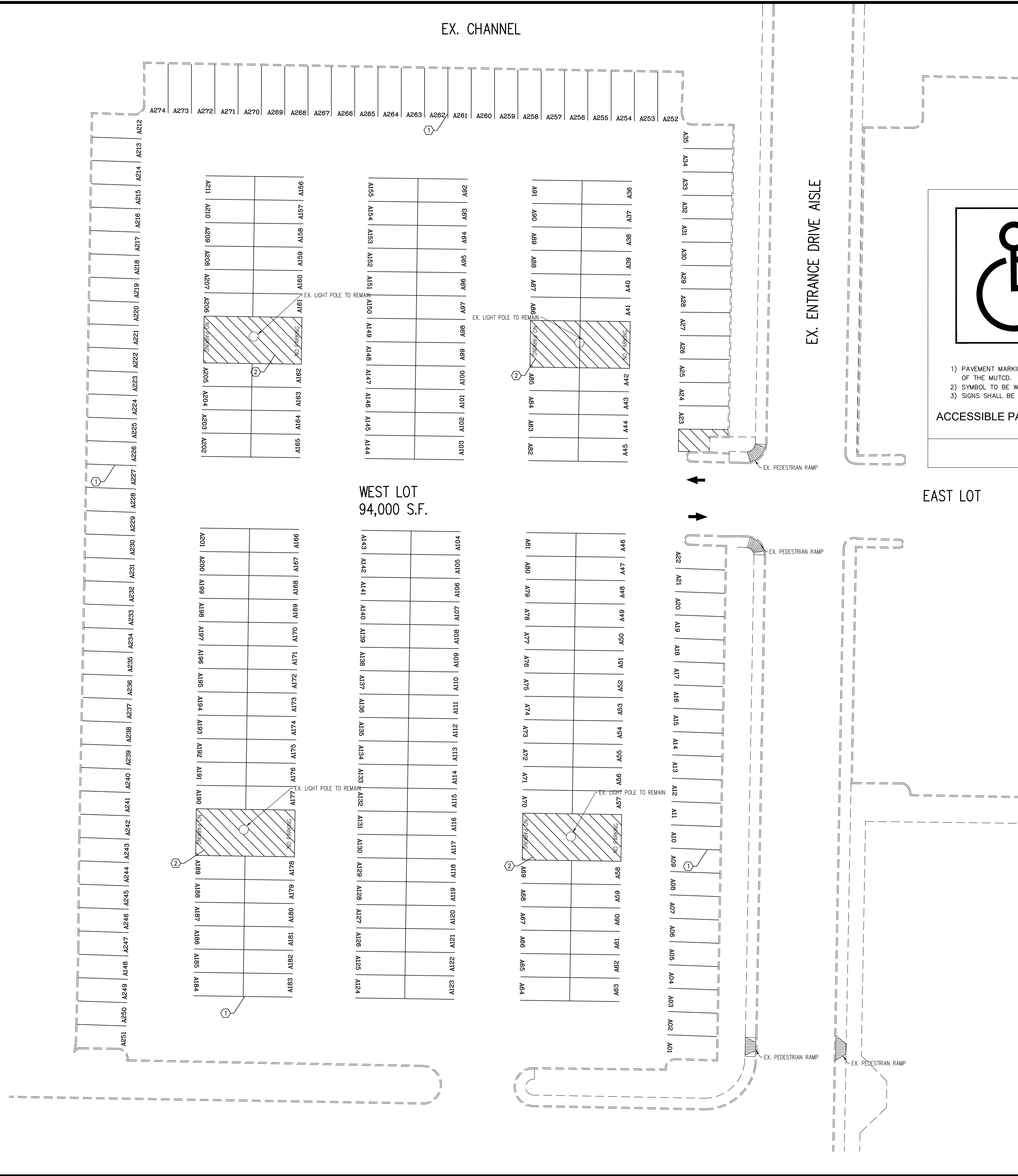

EX. CHANNEL

WEST LOT
94,000 S.F.

EAST LOT

EX. ENTRANCE DRIVE AISLE

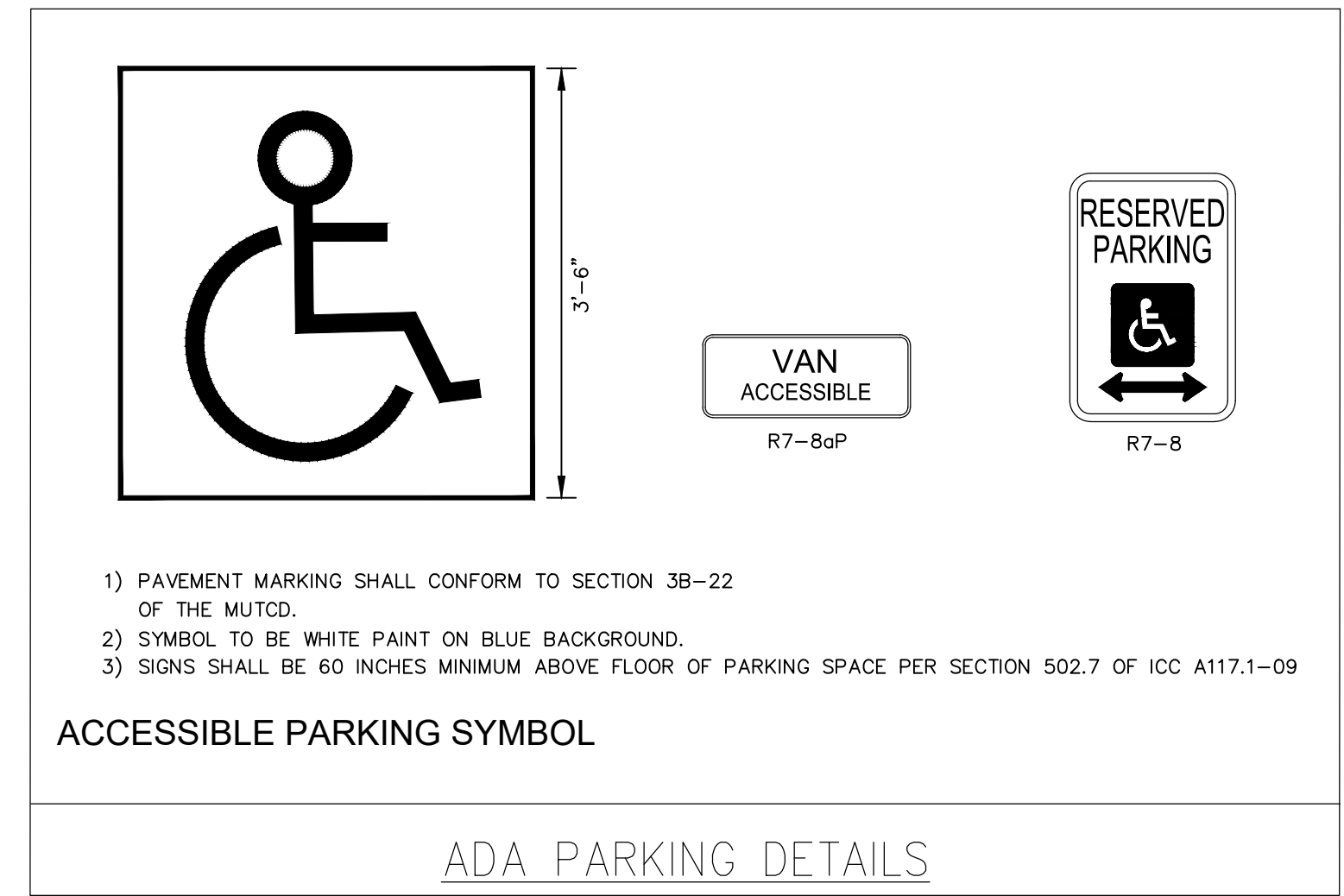
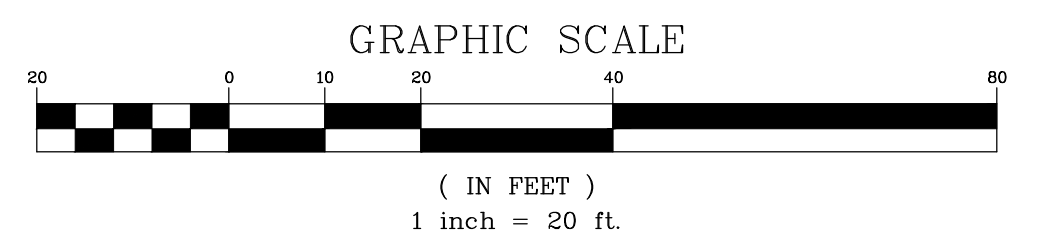

- 1) PAVEMENT MARKING SHALL CONFORM TO SECTION 3B-22 OF THE MUTCD.
- 2) SYMBOL TO BE WHITE PAINT ON BLUE BACKGROUND.
- 3) SIGNS SHALL BE 60 INCHES MINIMUM ABOVE FLOOR OF PARKING SPACE PER SECTION 502.7 OF ICC A117.1-09

ACCESSIBLE PARKING SYMBOL

ADA PARKING DETAILS

SIGNAGE AND STRIPING PLAN KEY NOTES

- 1) 4" WIDE WHITE PAVEMENT STRIPE TYP. (2 COATS OF PAINT)
- 2) 4" WIDE WHITE PAVEMENT STRIPE 2.5" O.C. @ 45° ANGLE TO STALL TYP. (2 COATS OF PAINT)
- 3) ACCESSIBLE PARKING SYMBOL TYP. (REF. DETAIL SHEET)
- 4) ACCESSIBLE PARKING SIGN TYP. (REF. DETAIL SHEET)
- 5) ACCESSIBLE PARKING SIGN WITH VAN ACCESSIBLE SIGN TYP. (REF. DETAIL SHEET)

NOTES

- 1. CONTRACTOR TO COORDINATE PHASING OF PARKING LOT CONSTRUCTION WITH CARSON CITY SCHOOL DISTRICT PRIOR TO THE COMMENCEMENT OF CONSTRUCTION.
- 2. ALL STALLS SHOWN ARE TO BE 9' WIDE AND 19' DEEP UNLESS NOTED OTHERWISE.
- 3. ALL STRIPING SHALL CONFORM TO THE LATEST VERSION OF THE MANUAL ON UNIFORM TRAFFIC CONTROL DEVICES (MUTCD) AND CARSON CITY STANDARD DETAILS.
- 4. STRIPING TO INCLUDE ADA ACCESS AISLES, STALL NUMBERING AND ARROWS AS WELL AS ALL ITEMS INCLUDED IN THE KEY NOTES.



NO.	DATE	REVISIONS

Manhard CONSULTING LTD
841 Ridge Street, Suite 400, Reno, NV 89501 ph: 775-748-9500 fax: 775-748-9500 manhard.com
Civil Engineers • Surveyors • Water Resource Engineers • Water & Wastewater Engineers
Construction Managers • Environmental Scientists • Landscape Architects • Planners

CARSON HIGH SCHOOL PARKING LOT
CARSON CITY, NEVADA
SIGNAGE AND STRIPING-WEST LOT



PROJ. MGR.: TJS
PROJ. ASSOC.: AR
DRAWN BY: AR
DATE: 3/06/24
SCALE: AS SHOWN

CONSTRUCTION DRAWINGS

